

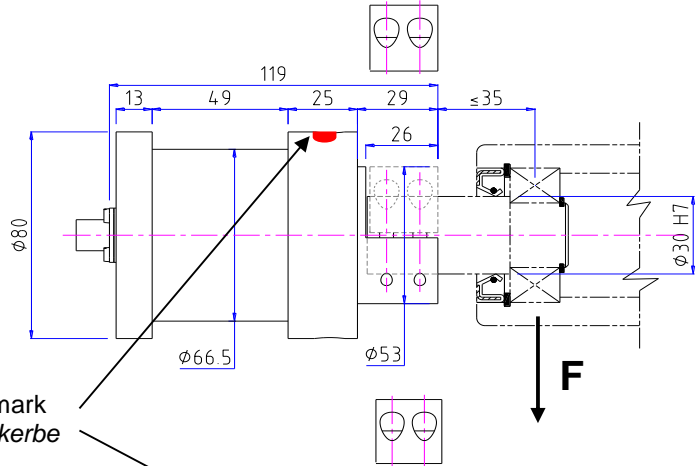

ATB - CS

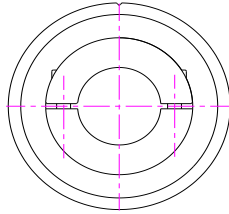

ATB - 2CS

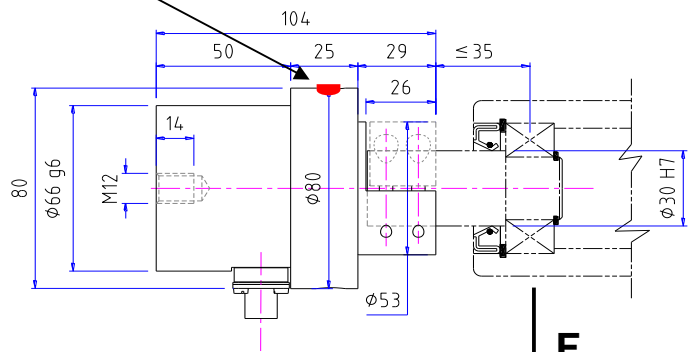
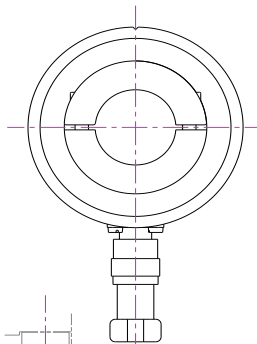

Dimensions in mm
Abmessungen in mm

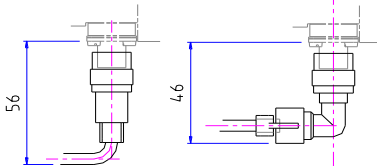

Quality load cell with highest reliability for web tension measuring; mechanical overload protection built-in; wide range of nominal forces; to be mounted easily in order to allow the measuring of any angle of web paths.

Qualitativ hochwertiger und extrem zuverlässiger Kraftmesssensor zur Bahnzugmessung; mit integriertem mechanischem Überlastschutz; große Bandbreite an Nominalmessbereichen verfügbar; einfach zu montieren und leicht auszurichten, um jeden Umschlingungswinkel des laufenden Materials hinsichtlich der Messung zu berücksichtigen.

Nominal Force F (N)
Messbereich F (N)

50	125	250
500	750	1000

Technical Data

Technische Daten

- Max. working load (limit load)	200% F	- maximale Gebrauchslast (Grenzlast)
- Ultimate Load	> 300% F	- Bruchlast
- Sensitivity	1.5 mV / V	- Empfindlichkeit
- Accuracy	< 0.2 % F	- Genauigkeit
- Repeatability	< 0.2 % F	- Wiederholgenauigkeit
- Total error	< 0.3 % F	- Totalfehler
- Zero bridge balance	± 1% F	- Nullpunktabweichung
- Temperature effect on zero	± 0.1% F / 10 °C	- Temperatureinfluß auf den Nullpunkt
- Nominal temperature	+10 ... +60 °C +10 ... +120 °C	- Nominaltemperaturbereich
- Working temperature	-10 ... +80 °C -10 ... +130 °C	- Arbeitstemperaturbereich
- Bridge resistance	350 ohm	- Brückenwiderstand
- Maximum supply voltage	12 Vdc	- Max. Speisespannung
- Protection Level	IP54	- Schutzgrad
- Material	Steel / Stahl	- Material
- Connector	MIL	- Anschlußstecker

**ASSEMBLING EXAMPLES
EINBAUBEISPIELE**

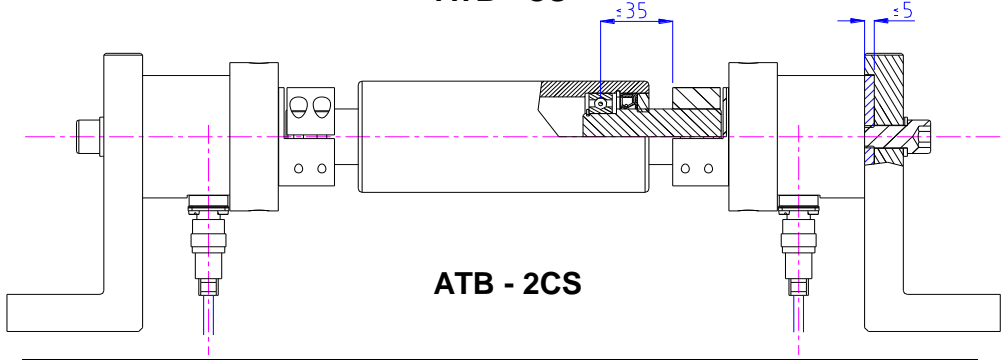
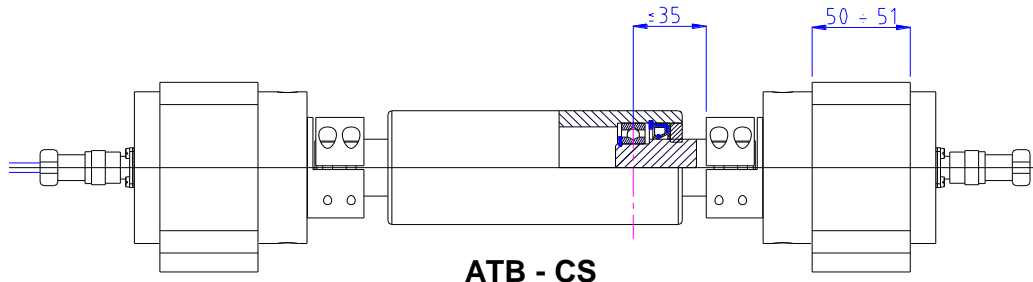

Male connector Zwitterstecker	Suggested Female connector Empfohlen Steckerhülse (90°)	
IPT02A8-4PN436	IPT06A8-4S(SR)N436	IPT08EM8-4S

**ELECTRICAL CONNECTION
ELEKTRISCHE ANSCHLÜSSE**

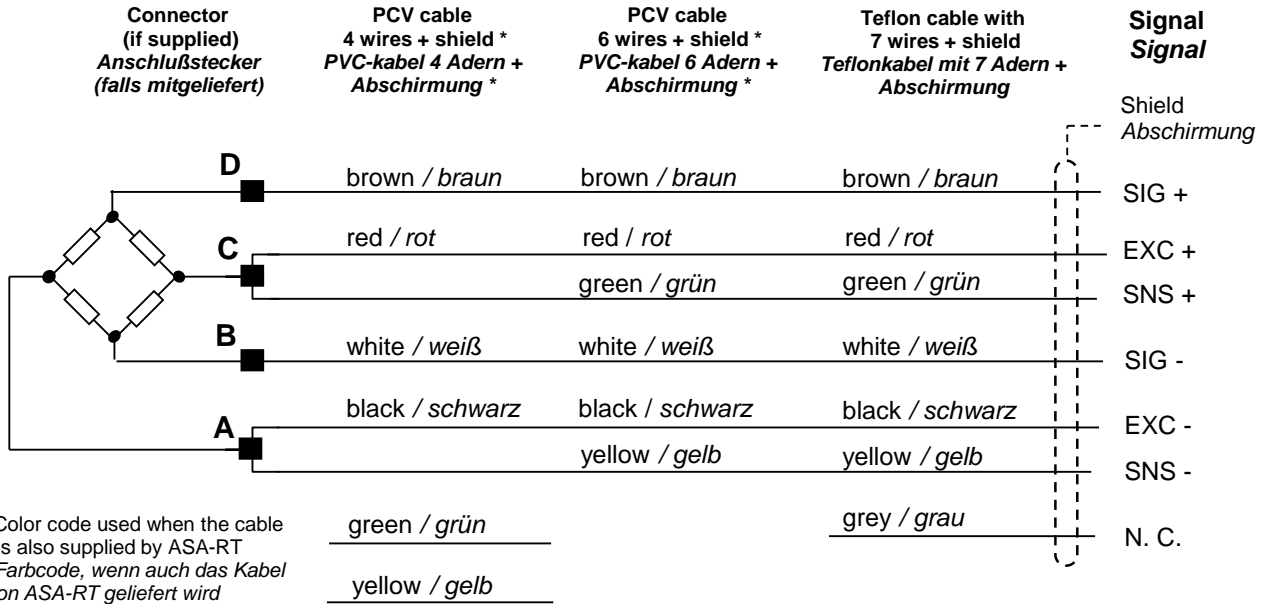

**ORDER CODE
BESTELLCODE**

