

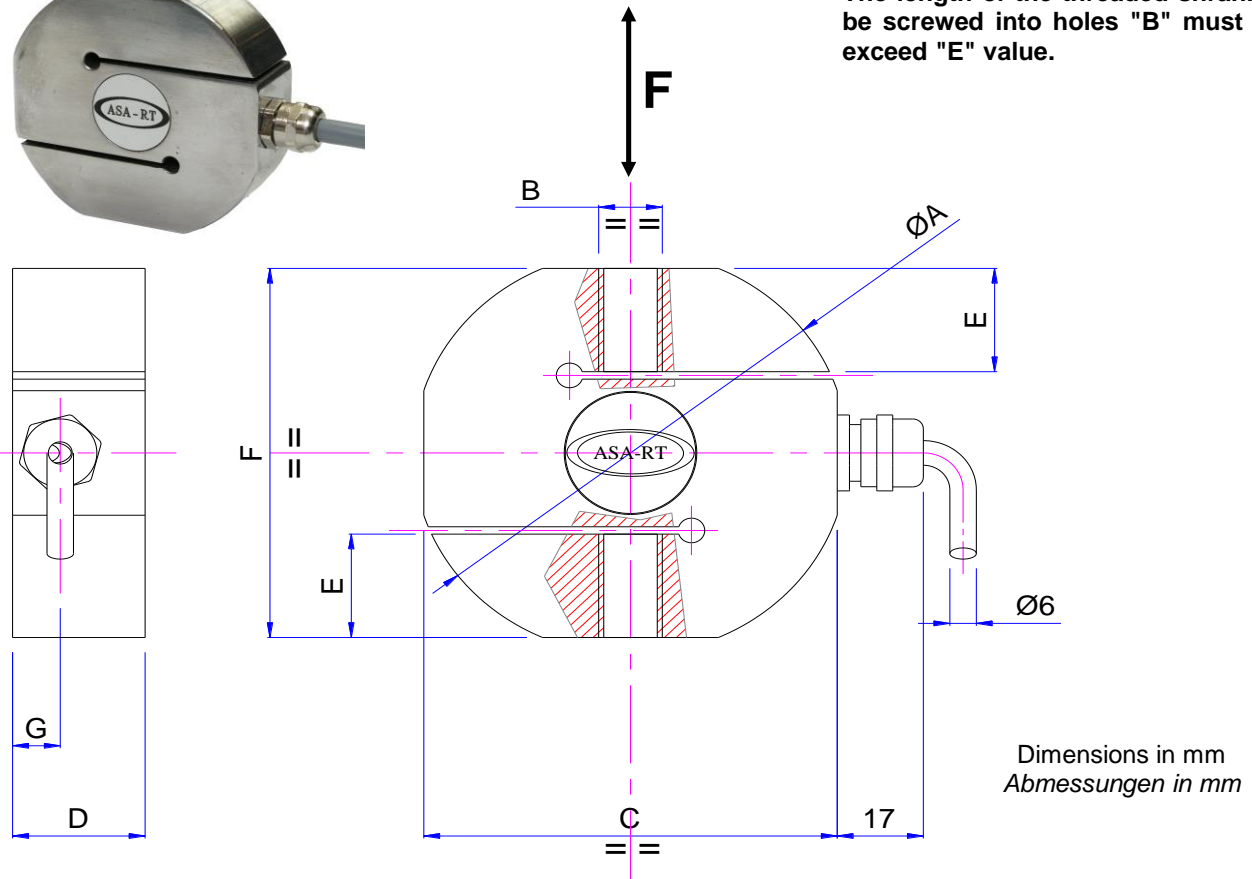

The length of the threaded shank to be screwed into holes "B" must not exceed "E" value.



Nominal Force F (Kg) Meßbereich F (Kg)		A	B	C	D	E	F	G	Sensitivity Empfindlichkeit
500	1000	82	M12x1,75	78	25	18	75	7,5	2 mV/V
2000	2500	82	M20x1,5	78	30	21	75	9	2 mV/V
5000	7500	102	M24x2	90	45	24	90	12	1 mV/V

Technical Data		Technische Daten
- Limit Load	150 % F	- Grenzlast
- Ultimate Load	> 300 % F	- Bruchlast
- Accuracy	< 0.2 % F	- Genauigkeit
- Repeatability	< 0.2 % F	- Wiederholgenauigkeit
- Combined error	< 0.3 % F	- Totalfehler
- Zero bridge balance	± 1 % F	- Nullpunktabweichung
- Temperature effect on zero	± 0.1% F / 10 °C	- Temperatureinfluß auf den Nullpunkt
- Nominal temperature	+10 ... +60 °C	- Nominaltemperaturbereich
- Working temperature	-10 ... +80 °C	- Arbeitstemperaturbereich
- Bridge resistance	350 Ohm	- Brückenwiderstand
- Maximum supply voltage	12 Vdc	- Max. Speisespannung
- Protection Level	IP65	- Schutzgrad
- Material	Stainless steel rostbeständiger Edelstahl	- Material
- Cable length	3 m	- Kabellänge
- Insulation resistance	> 10 Gohm	- Isolationswiderstand

**ASSEMBLING EXAMPLE
EINBAUBEISPIEL**

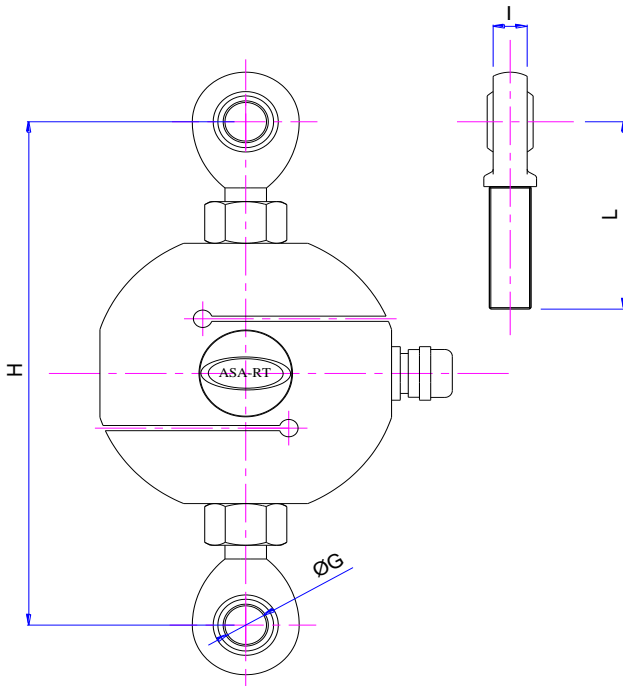

**Ball and socket joint not included
Kugelgelenkwelle nicht in Lieferumfang**

Nominal Force F (Kg) Meßbereich F (Kg)		G	H	I	L
500	1000	12	>147	8,5÷12	54
2000	2500	20	>189	13,5÷18	78
5000	7500	25	>230	18	94

**ELECTRICAL CONNECTION
ELEKTRISCHE ANSCHLÜSSE**

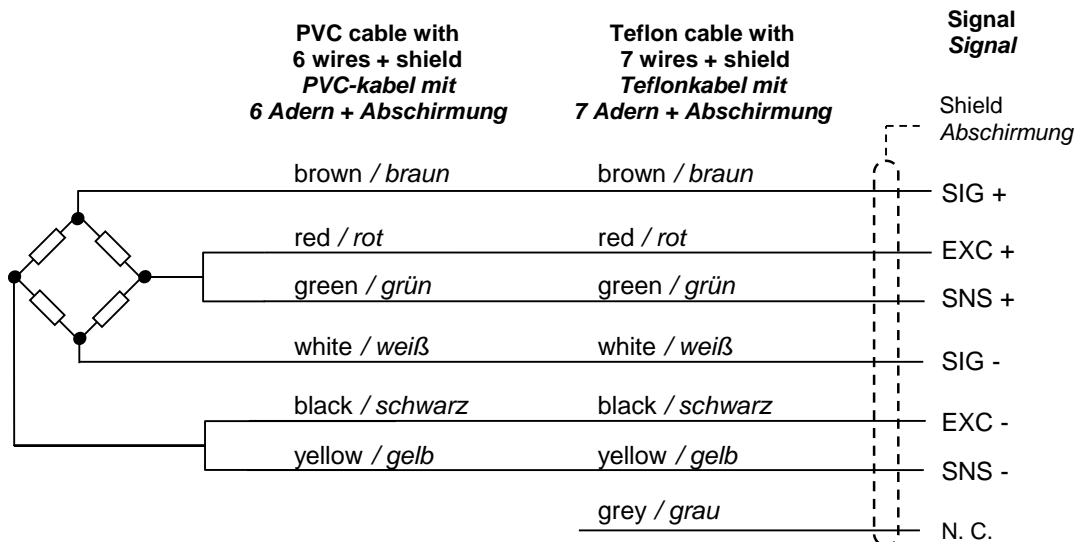

**ORDER CODE
BESTELLCODE**

